

# UCF-02-SYSTEM

## Quick-Connect Installation

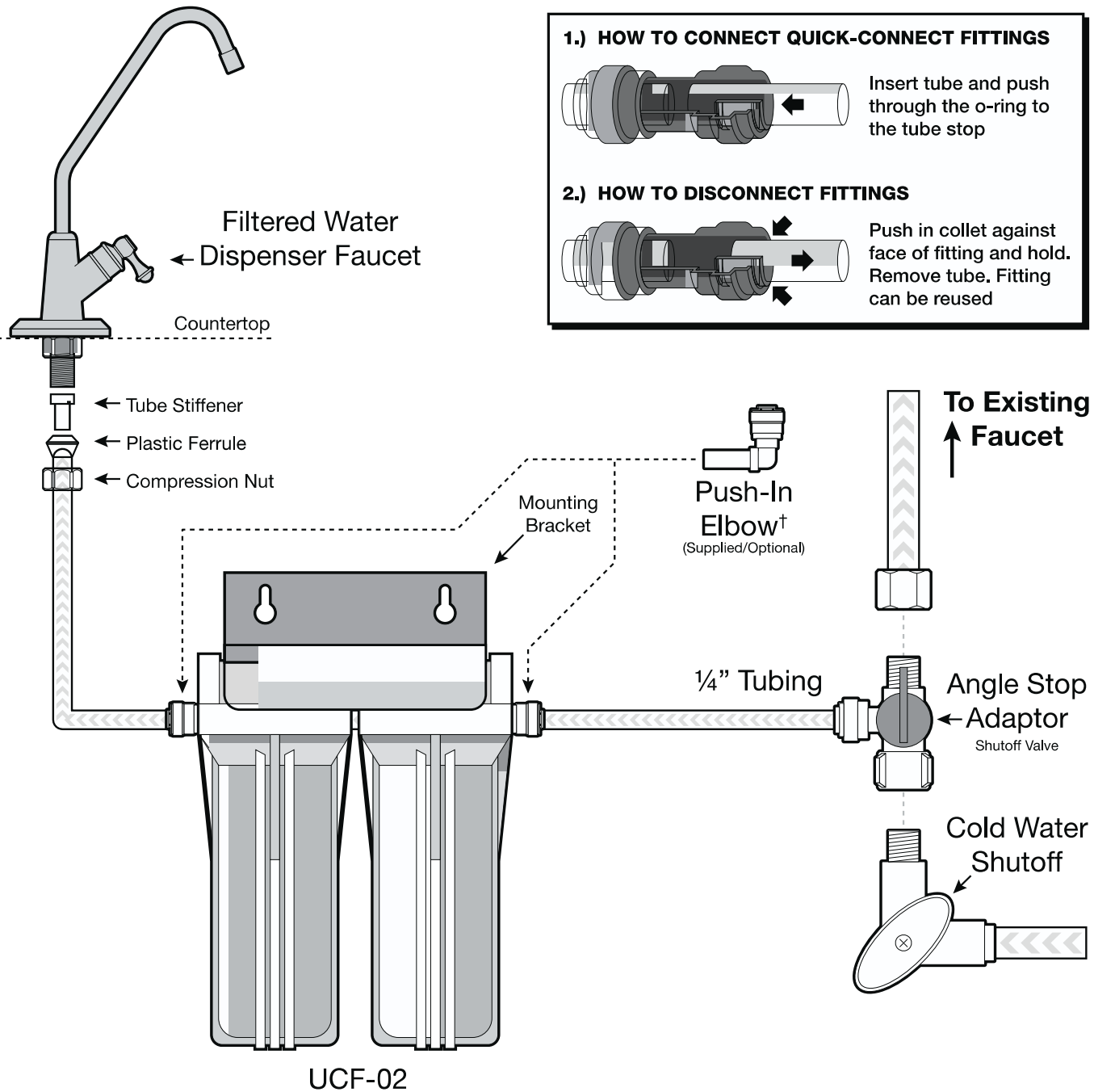

### Enclosed Parts List:

- (1) 9' × 1/4" Tubing
- (1) Tube Stiffener
- (1) Angle Stop Adaptor
- (1) Plastic Ferrule
- (1) Long Reach Faucet
- (1) Compression Nut
- (1) Housing Wrench
- (2) Push-In Elbow Fittings†

### Replacement Parts:

† Use of the push-in elbow fittings is optional to create swivel elbow if desired.

# UCF-02-SYSTEM

## Quick-Connect Installation

### UCF-02-System Installation Instructions For 3/8" copper or plastic, non-braided tubing

1. Shut-off cold water supply at the cold water shut-off valve.
2. Relieve the pressure by opening the cold water faucet on the sink.
3. (Optional) Mount the filter to the side of the cabinet with 2 screws. (Not supplied)
4. Cut riser tube a few inches above the cold water shut-off valve using a copper tubing cutter, plastic tubing cutter or razor knife. Make sure tubing has straight cuts on each end.
5. Cut supplied 1/4" plastic tubing into 2 equal lengths.
6. Connect a supplied 1/4" quick-connect elbow fitting to each length of 1/4" tubing. See diagram.
7. Connect the other side of 1/4" quick-connect elbows to each tube end created by the cut made in the riser tube.
8. Connect a length of tubing between the riser tube connected to cold water shut-off, using 1/4" Quick-Connect elbow fitting. Connect the other end of tubing to filter inlet fitting.
9. Connect the other length of tubing between the outlet port of the filter and the riser tube that goes up to the faucet.
10. Turn on the cold water and flush water through the system for 5 minutes.
11. Turn off the faucet and check all connections for leaks.

