

# RUS-200-SYSTEM

## Quick-Connect Installation

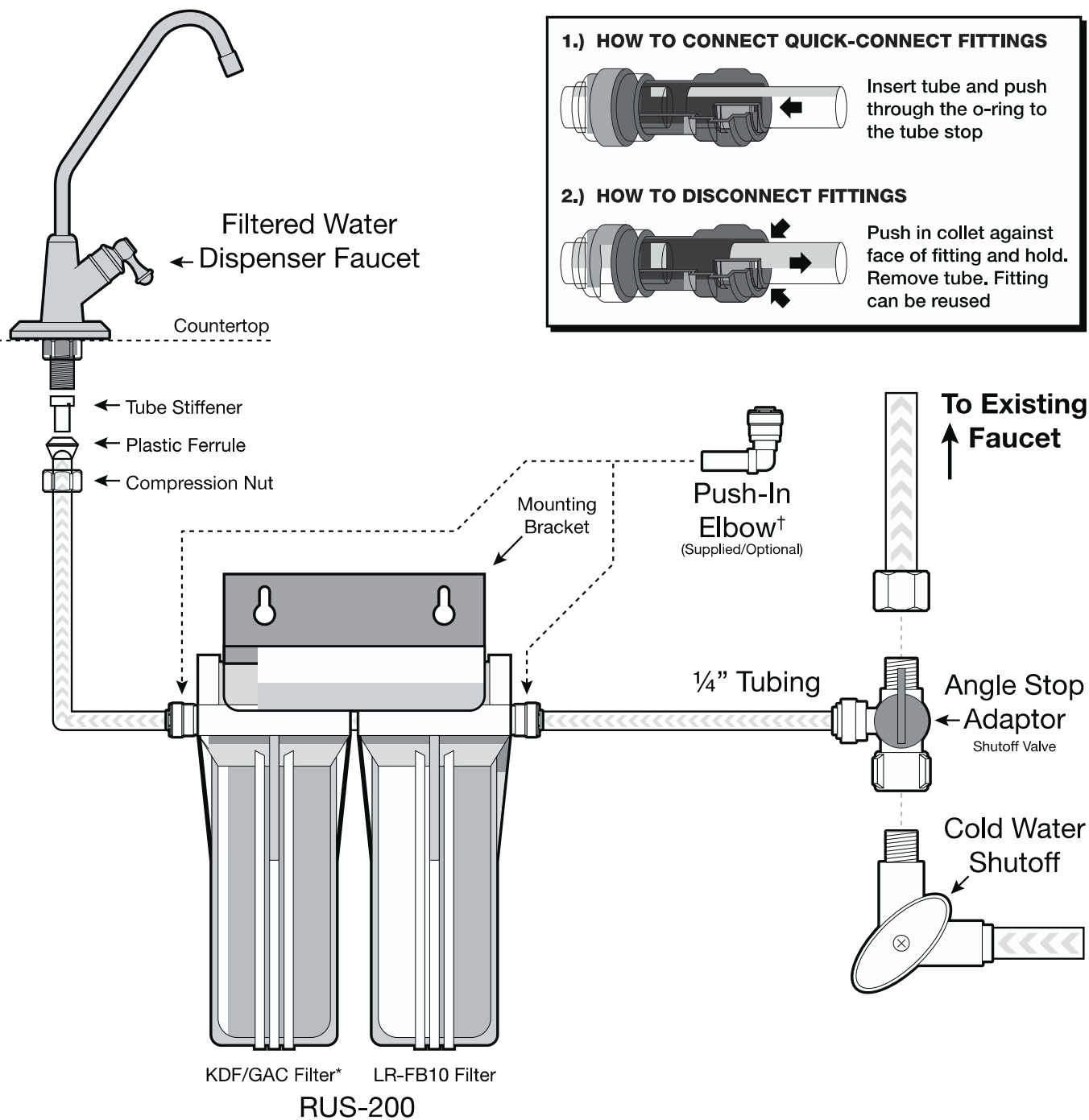

## Enclosed Parts List:

- |                             |                     |
|-----------------------------|---------------------|
| (1) 6' x 1/4" Tubing        | (1) Tube Stiffener  |
| (1) Angle Stop Adaptor      | (1) Plastic Ferrule |
| (1) Long Reach Faucet       | (1) Compression Nut |
| (1) Housing Wrench          |                     |
| (2) Push-In Elbow Fittings† |                     |

† Use of the push-in elbow fittings is optional to create swivel elbow if desired.

\* The KDF/GAC cartridge must be flushed out before service. However it is not recommended to flush it on to another filter element. We recommend putting the KDF/GAC in the 2nd position to flush it out, and then in the 1st position for the service run.

## Replacement Parts:

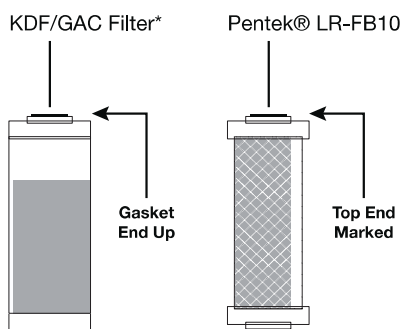

# RUS-200-SYSTEM

## Quick-Connect Installation

---

### **RUS-200-System Installation Instructions**

#### **For 3/8" riser tubes**

- 1.** Shut-off cold water supply at the cold water shut-off valve.
- 2.** Relieve the pressure by opening the cold water faucet on the sink.
- 3.** (Optional) Mount the filter to the side of the cabinet with 2 screws. (Not supplied)
- 4.** Cut riser tube a few inches above the cold water shut-off valve using a copper tubing cutter, plastic tubing cutter or razor knife. Make sure tubing has straight cuts on each end.
- 5.** Cut supplied 3/8 plastic tubing into 2 lengths.
- 6.** Connect a supplied 3/8 quick-connect elbow fitting to each length of 3/8 tubing. See diagram.
- 7.** Connect the other side of 3/8 quick-connect elbows to each tube end created by the cut made in the riser tube.
- 8.** Connect tube originating from cold water shut-off valve to the inlet port of the filter.
- 9.** Connect the outlet side of the filter to the tubing connected to the riser tube.
- 10.** Turn on the cold water and flush water through the system for 5 minutes.
- 11.** Turn off the faucet and check all connections for leaks.