

# JG John Guest

## How to make a Quick-Connect Connection

To make a connection, the tube is simply pushed in by hand. The unique patented John Guest collet locking system then holds the tube firmly in place without deforming it or restricting flow.

### 1 Cut tube square

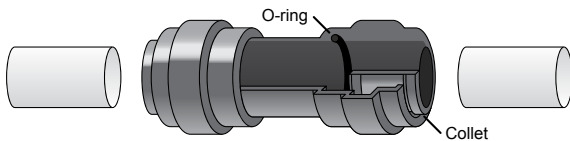

Cut the tube square. It is essential that the outside diameter be free of score marks and that burrs and sharp edges be removed before inserting into fitting. For soft thin walled plastic tubing we recommend the use of a tube insert.

### 2 Insert tube

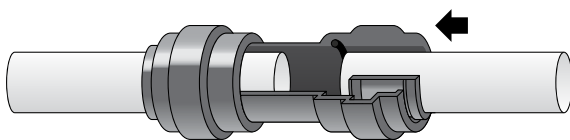

Fitting grips before it seals. Ensure tube is pushed into the tube stop.

### 3 Push up to tube stop

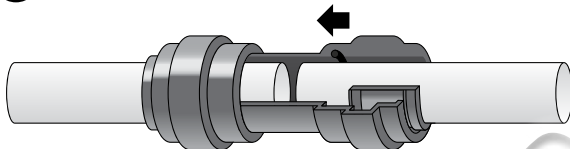

Push the tube into the fitting, to the tube stop. The collet (gripper) has stainless steel teeth which hold the tube firmly in position while the O-ring provides a permanent leak-proof seal.

### 4 Pull to check secure

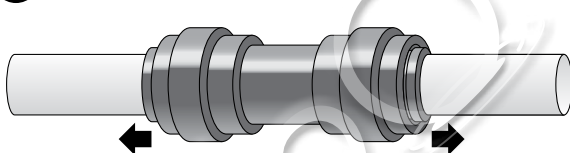

Pull on the tube to check that it is secure. It is a good practice to test the system prior to leaving site and/or before use.

### 5 Disconnecting

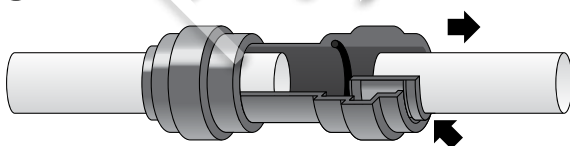

To disconnect, ensure the system is depressurized before removing the tube. Push in collet squarely against face of fitting. With the collet held in this position, the tube can be removed. The fitting can then be re-used.

For detailed Technical Specifications refer to product catalogs or visit our website at: [www.johnguest.com](http://www.johnguest.com). To request a copy of our Operating & Installation Guide contact us at: 1-800-94 JG USA or email: [info@jgusa.com](mailto:info@jgusa.com).

