

RUS-200-SYSTEM

Quick-Connect Installation

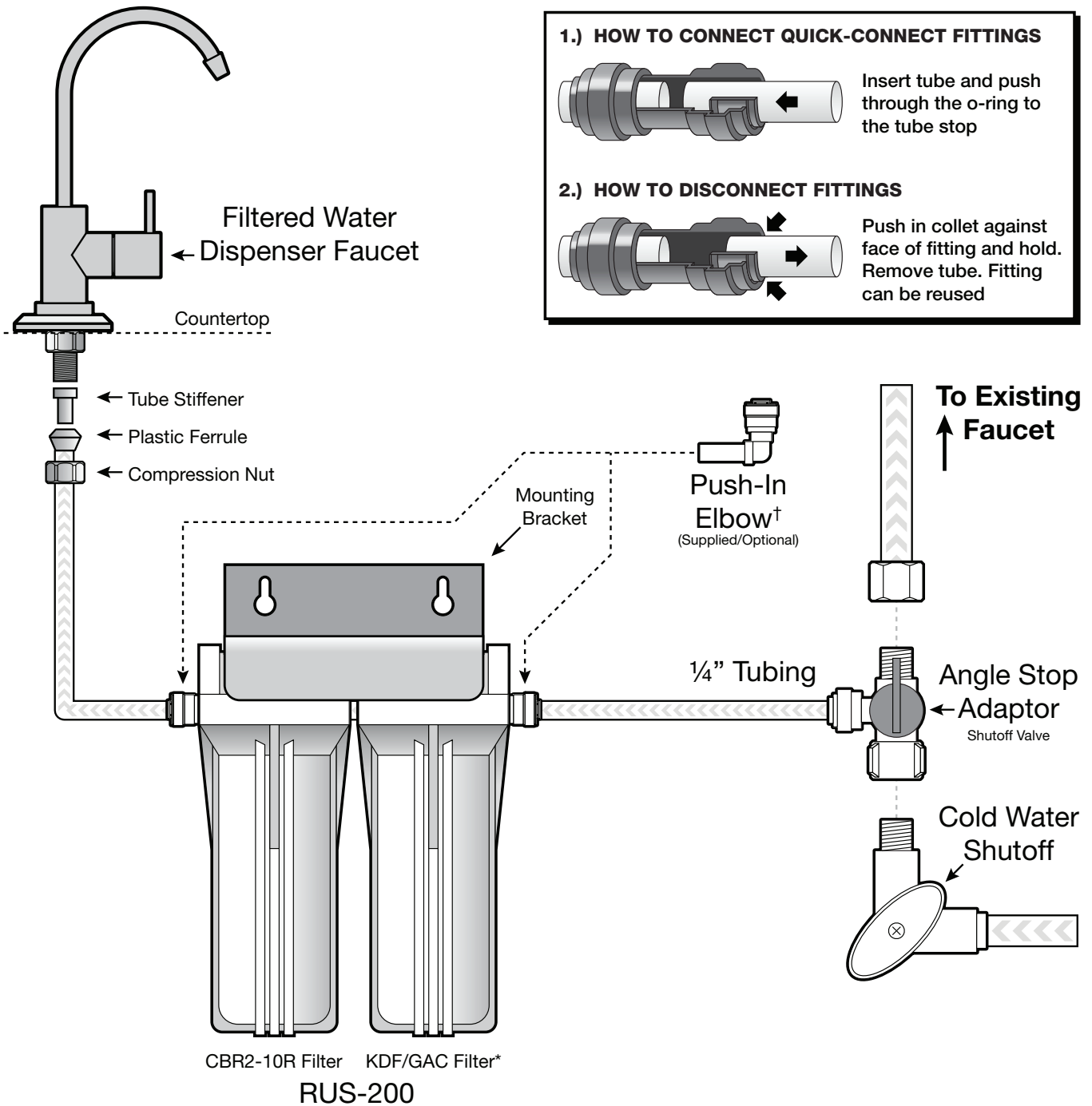

Enclosed Parts List:

- | | |
|-----------------------------|---------------------|
| (1) 6' x 1/4" Tubing | (1) Tube Stiffener |
| (1) Angle Stop Adaptor | (1) Plastic Ferrule |
| (1) Long Reach Faucet | (1) Compression Nut |
| (1) Housing Wrench | |
| (2) Push-In Elbow Fittings† | |

† Use of the push-in elbow fittings is optional to create swivel elbow if desired.

* The KDF/GAC cartridge must be flushed out before service. However it is not recommended to flush it on to another filter element. We recommend putting the KDF/GAC in the 2nd position to flush it out, and then in the 1st position for the service run.

Replacement Parts:

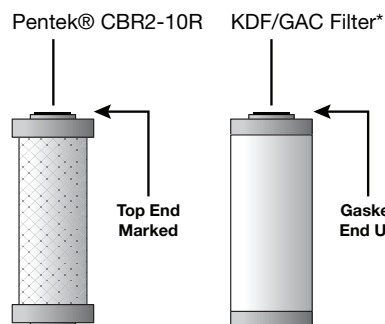

RUS-200-SYSTEM

Quick-Connect Installation

RUS-200-System Installation Instructions

For 3/8" riser tubes

1. Shut-off cold water supply at the cold water shut-off valve.
2. Relieve the pressure by opening the cold water faucet on the sink.
3. (Optional) Mount the filter to the side of the cabinet with 2 screws. (Not supplied)
4. Cut riser tube a few inches above the cold water shut-off valve using a copper tubing cutter, plastic tubing cutter or razor knife. Make sure tubing has straight cuts on each end.
5. Cut supplied 3/8 plastic tubing into 2 lengths.
6. Connect a supplied 3/8 quick-connect elbow fitting to each length of 3/8 tubing. See diagram.
7. Connect the other side of 3/8 quick-connect elbows to each tube end created by the cut made in the riser tube.
8. Connect tube originating from cold water shut-off valve to the inlet port of the filter.
9. Connect the outlet side of the filter to the tubing connected to the riser tube.
10. Turn on the cold water and flush water through the system for 5 minutes.
11. Turn off the faucet and check all connections for leaks.